

# Redefining Building.



## con·fi·dent

noun |'kän-fə-dənt|

What you feel when you work with the best ICFs in the industry:

- 1 High energy efficiency,
- 2 Providing big savings on heating and cooling costs,
- 3 A cost effective and faster build, and
- 4 The best support in the ICF industry.
- 5 **Redefining building.**

# ARXX™ ICF

Redefining building.

Product Catalogue: ARXX Edge | ARXX Prime | ARXX Steel

# ARXX™ Edge | Product Catalogue

ARXX Edge Forms and Accessories

Note: all forms are identified by the nominal concrete core thickness.

	SKU	EPS	length	width	height	weight	package
standard panel block (2 panels per form)	EB16-0-STD	2 ½"	48"	2 ½"	16"	5.8lbs.	6



\*Note: requires two panels per form.

	SKU	EPS	length	width	height	weight	package
4" corner form (2 panels per form)	EB16-4-90	2 ½"	16", 32"	9"	16"	5 lbs.	3L / 3R

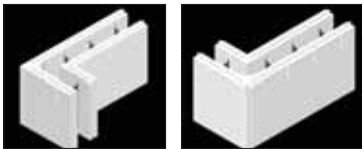

\*Note: connectors not included

	SKU	EPS	length	width	height	weight	package
6" 90° corner (2 panels per form)	EB16-6-90	2 ½"	16", 32"	11"	16"	4.9 lbs.	3L / 3R

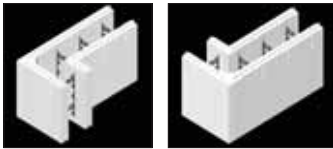

\*Note: connectors not included

	SKU	EPS	length	width	height	weight	package
8" 90° corner (2 panels per form)	EB16-8-90	2 ½"	16", 32"	13"	16"	4.8 lbs.	3L / 3R

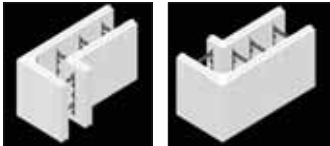

\*Note: connectors not included

	SKU	EPS	length	width	height	weight	package
brick ledge (per one panel)	EB16-0-EXT	2 ½"	48"	N/A	16"	3.6 lbs.	6



	SKU	EPS	length	width	height	weight	package
taper top (2 panels per form)	EB16-0-TAPERTOP	2 ½"	48"	2 ½"	16"	5.8 lbs.	6



**ARXX™ ICF**  
Redefining building.

# ARXX™ Edge | Product Catalogue

ARXX Edge Forms and Accessories

	SKU	EPS	length	width	height	weight	package
6" 45° corner	EB16-6-45	2 ½"	16", 32"	11"	16"	4.8 lbs.	4



\*Note: connectors not included

	SKU	length	width	height	weight	package
4" connector	EB04-0-CONN	-	-	-	-	1000

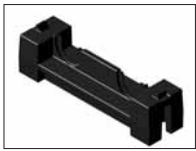

	SKU	length	width	height	weight	package
5" connector	EB05-0-CONN	-	-	-	-	1000



	SKU	length	width	height	weight	package
6" connector	EB06-0-CONN	-	-	-	-	500

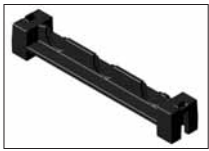

	SKU	length	width	height	weight	package
8" connector	EB08-0-CONN	-	-	-	-	500



	SKU	length	width	height	weight	package
10" connector	EB10-0-CONN	-	-	-	-	500



**ARXX™ ICF**  
Redefining building.

# ARXX™ Edge | Product Catalogue

ARXX Edge Forms and Accessories

	SKU	length	width	height	weight	package
tie connector	EB0T-0-ANCHOR	-	-	-	-	500

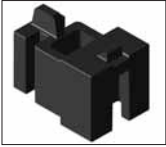

	SKU	length	width	height	weight	package
splice connector	EB0S-0-CONN	-	-	-	-	1000



	SKU	length	width	height	weight	package
brick ledge rail	EB0B-0-RAIL	48"	-	-	-	50

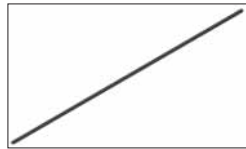

	SKU	length	width	height	weight	package
90° panel connector	EB16-90-CONN	47"	5.25"	2.85"	2.45	8

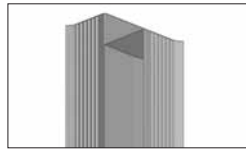

	SKU	length	width	height	weight	package
45° panel connector	EB16-45-CONN	47"	5.25"	3.5"	2.95	8

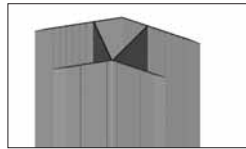

# ARXX<sup>TM</sup> Prime | Product Catalogue

ARXX Prime Forms and Accessories

Note: all forms are identified by the nominal concrete core thickness.

	SKU	EPS	length	width	height	weight	package
4" standard - concealed two side	BL04-2-STD	2 1/2"	48"	9"	16 3/4"	5.7 lbs.	15



	SKU	EPS	length	width	height	weight	package
4" 90° corner - concealed two side	BL04-2-90	2 1/2"	16", 32"	9"	16 3/4"	5 lbs.	2L / 2R

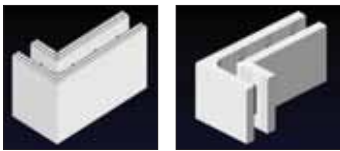

	SKU	EPS	length	width	height	weight	package
6" standard	BL06-E-STD	2 5/8"	48"	11 1/2"	16 3/4"	7 lbs.	12
6" standard - concealed one side	BL06-1-STD	2 5/8"	48"	11 1/2"	16 3/4"	7 lbs.	12

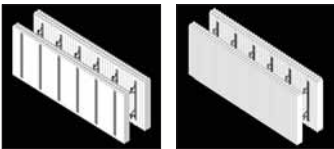

	SKU	EPS	length	width	height	weight	package
6" 90° corner	BL06-E-90	2 5/8"	16", 32"	11 1/2"	16 3/4"	5 lbs.	2L / 2R
6" 90° corner - concealed two side	BL06-2-90	2 5/8"	16", 32"	11 1/2"	16 3/4"	5 lbs.	2L / 2R

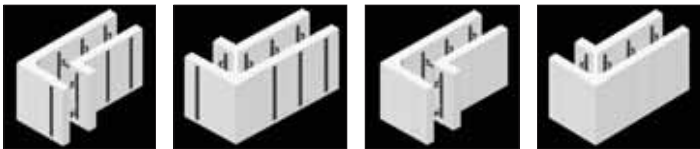

	SKU	EPS	length	width	height	weight	package
6" double 45° corner	BL06-2-45	2 5/8"	40"	11 1/2"	16 3/4"	7 lbs.	9



	SKU	EPS	length	width	height	weight	package
6" extended brick ledge	BL06-E-EXT	2 5/8"	48"	11 1/2", 15 1/2"	16 3/4"	7 lbs.	9



**ARXX<sup>TM</sup> ICF**  
Redefining building.

# ARXX<sup>™</sup> Prime | Product Catalogue

ARXX Prime Forms and Accessories

	SKU	EPS	length	width	height	weight	package
6" end cap	BL06-0-END	2 3/8"	6 1/4"	2 1/4"	16 3/4"	1/4 lbs.	50

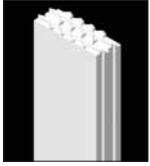

	SKU	EPS	length	width	height	weight	package
6"– 12" high standard - concealed one side	BL06-1-STD12	2 3/8"	48"	11 1/2"	12"	6 lbs.	16

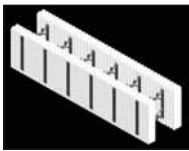

	SKU	EPS	length	width	height	weight	package
6"– 12" high corner - concealed one side	BL06-1-9012	2 3/8"	16", 32"	11 1/2"	12"	5 lbs.	2L / 2R

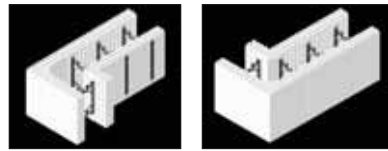

	SKU	EPS	length	width	height	weight	package
6" taper top form	BL06-E-TOP	2 3/8"	48"	11 1/2"	16 3/4"	6 lbs.	11



	SKU	EPS	length	width	height	weight	package
8" standard	BL08-E-STD	2 3/8"	48"	12 1/2"	16 3/4"	7 lbs.	12
8" standard - concealed one side	BL08-1-STD	2 3/8"	48"	12 1/2"	16 3/4"	7 lbs.	12

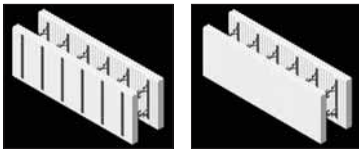

	SKU	EPS	length	width	height	weight	package
8" 90° corner	BL08-E-90	2 3/8"	16", 32"	12 1/2"	16 3/4"	4 lbs.	2L / 2R
8" 90° corner - concealed two sides	BL08-2-90	2 3/8"	16", 32"	12 1/2"	16 3/4"	4 lbs.	2L / 2R

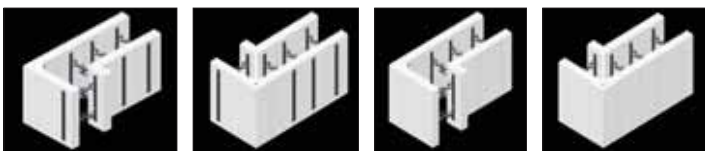

**ARXX<sup>™</sup> ICF**  
Redefining building.

# ARXX<sup>™</sup> Prime | Product Catalogue

ARXX Prime Forms and Accessories

	SKU	EPS	length	width	height	weight	package
--	-----	-----	--------	-------	--------	--------	---------

8" double 45° corner

BL08-2-45

2 3/8"

40"

12 1/2"

16 3/4"

7 lbs.

9



	SKU	EPS	length	width	height	weight	package
--	-----	-----	--------	-------	--------	--------	---------

8" brick ledge

BL08-E-EXT

2 3/8"

48"

16 1/2"

16 3/4"

7 lbs.

9



	SKU	EPS	length	width	height	weight	package
--	-----	-----	--------	-------	--------	--------	---------

8" - 12" high standard - concealed one side

BL08-1-STD12

2 3/8"

48"

12 1/2"

12"

6 lbs.

16

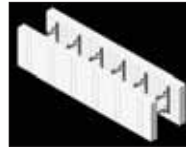

	SKU	EPS	length	width	height	weight	package
--	-----	-----	--------	-------	--------	--------	---------

8" - 12" high corner - concealed one side

BL08-1-9012

2 3/8"

16", 32"

12 1/2"

12"

5 lbs.

2L / 2R



	SKU	EPS	length	width	height	weight	package
--	-----	-----	--------	-------	--------	--------	---------

10" standard form - concealed one side

BL10-1-STD

2 1/2"

48"

15"

16 3/4"

7 lbs.

9

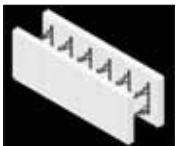

	SKU	EPS	length	width	height	weight	package
--	-----	-----	--------	-------	--------	--------	---------

10" 90° corner - concealed one side

BL10-1-90

2 3/8"

19 1/2", 17 1/2"

15"

16 3/4"

7 lbs.

2L / 2R



**ARXX<sup>™</sup> ICF**  
Redefining building.

# ARXX<sup>™</sup> Prime | Product Catalogue

ARXX Prime Forms and Accessories

	SKU	length	width	height	weight	package
4" ARXX Lok	RE04-0-ARXXLOK	96"	4"	3/8"	1.91 lbs.	12
6" ARXX Lok	RE06-0-ARXXLOK	96"	6 1/4"	3/8"	2.14 lbs.	12
8" ARXX Lok	RE08-0-ARXXLOK	96"	7 7/8"	3/8"	2.42 lbs.	12
10" ARXX Lok	RE10-0-ARXXLOK	96"	9 7/8"	3/8"	2.67 lbs.	12

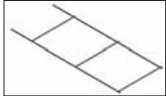

	SKU	length	width	height	weight	package
hook	RE00-0-HOOK	17.41"	4.32"	0.15"	N/A	250
claw	RE00-0-CLAW	7.88"	5.91"	0.15"	N/A	250



hook



claw

	SKU	length	width	height	weight	package
90° panel connector	EB16-90-CONN	47"	5.25"	2.85"	2.45	8

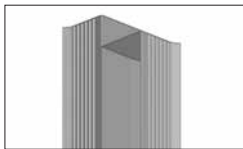

	SKU	length	width	height	weight	package
45° panel connector	EB16-45-CONN	47"	5.25"	3.5"	2.95	8

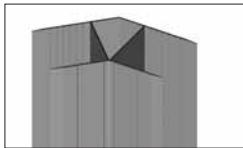

# ARXX<sup>™</sup> Steel | Product Catalogue

ARXX Steel and ARXX Steel Waffle Grid Forms and Accessories

Note: all forms are identified by the nominal concrete core thickness.

	SKU	EPS	length	width	height	weight	package
6" straight form	PS-4600-24	2 ½"	48"	11"	24"	14	8



	SKU	EPS	length	width	height	weight	package
6" 90° corner form	PS-4690-24	2 ½"	15", 39"	11"	24"	12.25	4L / 4R



	SKU	EPS	length	width	height	weight	package
6" 45° corner form	PS-4645-24	2 ½"	9"	11"	24"	2.75	18



	SKU	EPS	length	width	height	weight	package
8" straight form	PS-4800-24	2 ½"	48"	13"	24"	14.75	6



	SKU	EPS	length	width	height	weight	package
8" 90° corner	PS-4890-24	2 ½"	17", 41"	13"	24"	13.75	4L / 4R



	SKU	EPS	length	width	height	weight	package
8" 45° corner	PS-4845-24	2 ½"	10"	13"	24"	3.25	18

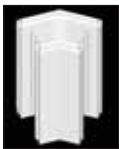

# ARXX<sup>™</sup> Steel | Product Catalogue

ARXX Steel and ARXX Steel Waffle Grid Forms and Accessories

	SKU	EPS	length	width	height	weight	package
waffle grid 6" straight form	PS-3600	1 1/2"	48"	9 1/4"	16"	6	12



	SKU	EPS	length	width	height	weight	package
waffle grid 6" 90° corner	PS-3690	1 1/2"	10 3/8", 34 3/8"	9 1/4"	16"	5.75	6L / 6R

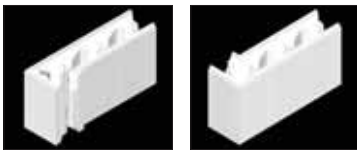

	SKU	EPS	length	width	height	weight	package
waffle grid 6" 45° corner	PS-3645	1 1/2"	7 15/16"	9 1/4"	16"	1.5	27



	SKU	EPS	length	width	height	weight	package
waffle grid 8" straight form	PS-3800	1 1/2"	48"	11"	16"	8.25	12



	SKU	EPS	length	width	height	weight	package
waffle grid 8" 90° corner	PS-3890	1 1/2"	11 1/2", 35 1/2"	11"	16"	6.25	6L / 6R



	SKU	EPS	length	width	height	weight	package
waffle grid 8" 45° corner	PS-3845	1 1/2"	8 9/16"	11"	16"	2	27



**ARXX<sup>™</sup> ICF**  
Redefining building.

# ARXX<sup>™</sup> Steel | Product Catalogue

ARXX Steel and ARXX Steel Waffle Grid Forms and Accessories

	SKU	length	width	height	weight	package
90° panel connector	EB16-90-CONN	47"	5 ¼"	2 7/8"	2.45	16

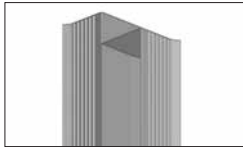

*\*Note: not available for ARXX Steel Waffle Grid forms.*

	SKU	length	width	height	weight	package
45° panel connector	EB16-45-CONN	47"	5 ¼"	3 ½"	2.95	9

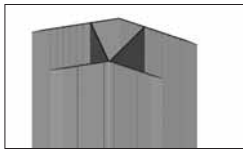

*\*Note: not available for ARXX Steel Waffle Grid forms.*

	Product Description	SKU	Block Dimensions				Surface		Concrete Volume		Pack			Full Pack Dimensions		
			Total Block W Inch	L Inch	Foam W		Area Sq Ft	Cubic Yards	Cubic Meters	Quantity	L Inch	W Inch	H Inch	Weight (lbs)		
					Inch	Inch									H Inch	Weight (lbs)
4"	ARXX – EDGE Straight Panel Block - 4" connector	EB16-0-STD / EB04-0-CONN	9	48	2 ½	16	6	5.333	0.070	0.066	6	33	17	48	35	
	ARXX – EDGE 4" 90° Corner	EB16-4-90	9	32 x 16	2 ½	16	5	5.333	0.063	0.040	6	32	19	49	30	
	ARXX – PRIME 4" Standard Form	BL04-2-STD	9	48	2 ½	16 ¾	6	5.583	0.069	0.053	15	45	48	51	90	
	ARXX – PRIME 4" 90° Corner	BL04-2-90	9	32 x 16	2 ½	16 ¾	5	5.583	0.057	0.043	4	25	32	34	20	
	ARXX – EDGE Straight Panel Block - 5" connector	EB16-0-STD / EB05-0-CONN	10	48	2 ½	16	6	5.333	0.082	0.063	6	33	17	48	36	
	ARXX – EDGE Straight Panel Block - 6" connectors	EB16-0-STD / EB06-0-CONN	11	48	2 ½	16	6	5.333	0.099	0.076	6	33	17	48	36	
	ARXX – EDGE 6" 90° Corner	EB16-6-90	11	32 x 16	2 ½	16	5	5.333	0.075	0.058	6	32	19	49	30	
	ARXX – PRIME 6" Standard Exposed and 1 Side Concealed	BL06-E-STD / BL06-1-STD	11 ½	48	2 ½	16 ¾	7	5.583	0.108	0.082	12	46 ½	48 ½	51	84	
	ARXX – PRIME 6" - 90° Corner Exposed and 2 Sides Concealed	BL06-E-90 / BL06-2-90	11 ½	32 x 16	2 ½	16 ¾	5	5.583	0.082	0.064	4	27 ½	32	34	20	
	ARXX – PRIME 6" - 12" High Standard	BL06-1-STD12	11 ½	48	2 ½	12	6	4.000	0.080	0.061	16	48	48	48	96	
6"	ARXX – PRIME 6" - 12" High Corner	BL06-1-9012	11 ½	32 x 16	2 ½	12	5	4.000	0.060	0.046	4	32	28	24	20	
	ARXX – STEEL 6" Straight Waffle Grid	PS-3600	9 ¼	48	1 ½	16	9	5.333	0.074	0.057	12	47	37	49	108	
	ARXX – STEEL 6" 90° Corner Waffle Grid	PS-3690	9 ¼	34 ¾ x 10 ¾	1 ½	16	6	5.030	0.060	0.046	12	36	40 ¼	49	72	
	ARXX – STEEL 6" 45° Corner Waffle Grid	PS-3645	9 ¼	7 <sup>15</sup> / <sub>16</sub>	1 ½	16	2	1.760	0.018	0.014	27	39 ½	39 ½	49	54	
	ARXX – STEEL 6" Straight Flat Wall	PS-4600-24	11	48	2 ½	24	10	8.000	0.148	0.113	8	49	44	49	80	
	ARXX – STEEL 6" 90° Corner Flat Wall	PS-4690-24	11	39 x 15	2 ½	24	12	9.000	0.125	0.095	8	39 ½	53	49	96	
	ARXX – STEEL 6" 45° Corner Flat Wall	PS-4645-24	11	9	2 ½	24	3	3.000	0.041	0.031	18	46	46	49	48	
	ARXX – EDGE Straight Panel Block - 8" connector	EB16-0-STD / EB08-0-CONN	13	48	2 ½	16	6	5.333	0.130	0.099	6	33	17	48	36	
	ARXX – EDGE 8" 90° Corner	EB16-8-90	13	32 x 16	2 ½	16	5	5.333	0.095	0.073	6	32	19	49	30	
	ARXX – PRIME 8" Standard Exposed and 1 Side Concealed	BL08-E-STD / BL08-1-STD	12 ½	48	2 ½	16 ¾	7	5.583	0.136	0.104	12	51	48 ½	51	84	
8"	ARXX – PRIME 8" - 90° Corner Exposed and 2 Sides Concealed	BL08-E-90 / BL08-2-90	12 ½	32 x 16	2 ½	16 ¾	5	5.583	0.100	0.077	4	29	32	34	20	
	ARXX – PRIME 8" - 12" High Standard	BL08-1-STD12	12 ½	48	2 ½	12	6	4.000	0.098	0.075	16	48	51	48	96	
	ARXX – PRIME 8" - 12" High Corner	BL08-1-9012	12 ½	32 x 16	2 ½	12	5	4.000	0.072	0.055	4	32	29	24	20	
	ARXX – STEEL 8" Straight Waffle Grid	PS-3800	11	48	1 ½	16	9	5.330	0.100	0.077	12	49	44	49	108	
	ARXX – STEEL 8" 90° Corner Waffle Grid	PS-3890	11	35 ½ x 11 ½	1 ½	16	6	5.220	0.080	0.061	12	36	46	49	72	
	ARXX – STEEL 8" 45° Corner Waffle Grid	PS-3845	11	8 <sup>9</sup> / <sub>16</sub>	1 ½	16	2	1.903	0.025	0.019	27	41 ½	41 ½	49	54	
	ARXX – STEEL 8" Flat Wall	PS-4800-24	13	48	2 ½	24	12	8.000	0.197	0.151	6	49	39	49	90	
	ARXX – STEEL 8" 90° Corner Flat Wall	PS-4890-24	13	41 x 17	2 ½	24	14	9.660	0.175	0.133	8	42	61 ½	49	112	
	ARXX – STEEL 8" 45° Corner Flat Wall	PS-4845-24	13	10	2 ½	24	4	3.330	0.060	0.046	18	48	48	49	72	
	ARXX – EDGE Straight Panel Block - 10" connector	EB16-0-STD / EB10-0-CONN	15	48	2 ½	16	6	5.333	0.160	0.121	6	33	17	48	36	
10"	ARXX – PRIME 10" Standard Form	BL10-1-STD	15	48	2 ½	16 ¾	7	5.583	0.170	0.130	9	48	47	51	63	
	ARXX – PRIME 10" 90° Corner	BL10-1-90	15	27 ½ x 19 ½	2 ½	16 ¾	7	5.460	0.114	0.087	4	32	32	34	28	
	ARXX – EDGE Straight Panel Block - 2 x 6" connectors	EB16-0-STD / EB06-0-CONN	17	48	2 ½	16	6	5.533	0.198	0.151	6	33	17	48	36	